

YOUR SOLUTION PARTNER IN
INDUSTRIAL
VALVE AUTOMATION...

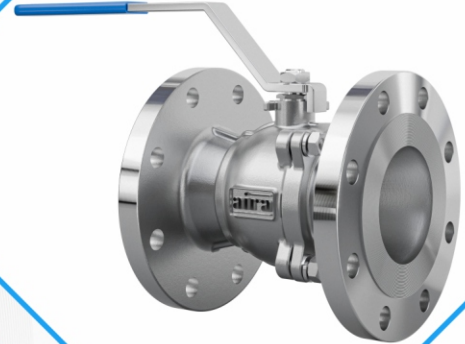

2PC REDUCE BORE DESIGN FLANGED BALL VALVE



APPROVALS



WEBSITE



Mfg. & Mkt by :

aira Euro automation pvt. ltd.

Ahmedabad-382405, INDIA.

www.airaindia.com





About Us

We welcome and thank you for referring out detailed catalogue.

aira is known all over continents as a manufacturer of quality products - Ball Valves, Butterfly Valves, Plug Valves, & Control On / Off Valves with Pneumatic Actuators for Pharma, Oil & Gas, Steel, Paper, Water, Chemical and all type of processing industries.

aira has walked through more than 3 decades, gaining valuable experience, offering equipment's in the products manufactured by OEMs in all spheres of engineering.

aira products have gained reputations of consultants, and approvals of users, OEMs and other as a quality product.

aira has expanding business into foreign markets specially GCC, UAE, Asian & African countries. This is because increase its customer base and revenue, leading to overall growth and success. Now foreign users come to know and believe in the services provided by the **aira**. Along with the same, it also helps to reach a large number of users thereby leading to the increase their business.

Being an ISO 9001 BVQI certified company has put **aira** in fore front. Our motto is "Value the customer" and "Superior product", one among the best in the world.

*Clients are
why we exist!*

Our Quality

- In- House full scale testing facility.
- Lean manufacturing practices
- Certified by : ISO 9001 : 2015 (BVQI LONDON), CE, ATEX, CIMFR, BIS, PESO, SIL 3, IBR
- API 609, API 6D

Our Commitment

- To understand customer's need first before proposing our products.
- To keep on providing competitive rates by adapting to continuous process improvement, without compromising on quality.
- To provide continuous support to our customers and go beyond their expectations in terms of delivery and after sale services.

Our Manufacturing Facility

- In house R & D, manufacturing and testing facility is all located in a spread over three campuses at Ahmedabad, Gujarat, INDIA.

Network - Sales Office

- 60 Plus Branch Offices in different states in India.
- Sales office in the Bangladesh, Dubai, Kenya, Malaysia, Nepal, Qatar, Singapore, South Africa, Sri Lanka, Turkey, USA (Expanding).

SIL 3 CERTIFICATIONS

CE CERTIFICATE



SIL 3 - PNEUMATIC ROTARY ACTUATORS



SIL 3 - BUTTERFLY VALVE



CE - BUTTERFLY VALVE

ISO CERTIFICATIONS



ISO 14001 : 2015



ISO 45001 : 2018



ISO 45001 : 2018



ISO 9001 : 2015



CERTIFICATIONS APPROVALS



QMS (Quality Management System)

ISO 9001 : 2015

EMS (Environment Management System)

ISO 14001 : 2015

OHSAS (Occupational Health & Safety Management System)

ISO 45001 : 2018

IBR
PISTON VALVE
GLOBE CONTROL VALVE (CKD/CND)
DISC CHECK VALVE (DCV)
PRESSURE REDUCING VALVE (PRV)
POP TYPE SAFETY VALVE
BALL VALVE

Pneumatic Actuator

CE /
ATEX /
EXIDA SIL-3 /
PROOF OF DESIGN

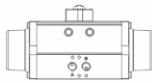

Scotch & Yoke Actuator

CE / ATEX / SIL-3

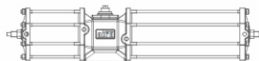

Stainless Steel Actuator

CE /
IEP ATEX

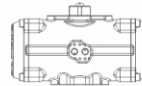

Positioner Enclosure

CE / CIMFR /
IP67 / BIS
/ PESO

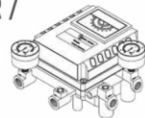

aira's
SOME OF OUR
Certificates

Plug Valve

FUGITIVE EMISSIONS
TEST
AS PER ISO
15848-1 / IBR

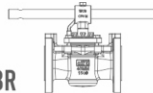

Flameproof Solenoid Valve

IEP ATEX / CE / CIMFR
/ IP65/ IP67 / IP68 /
BIS / PESO



Limit Switch

IEP ATEX / CE / CIMFR
/ IP67 / BIS / PESO /
EQDC IP68



Ball Valve (Floating & Trunnion)

FIRE SAFE TEST DESIGN /
FUGITIVE EMISSIONS TEST
AS PER ISO 15848-1 / CE /
PED /
EXIDA SIL-3

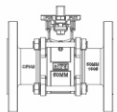

Butterfly Valve (centric / Double & Triple Eccentric)

FIRE SAFE TEST DESIGN /
FUGITIVE EMISSIONS TEST
AS PER ISO 15848-1 / CE /
PED / EXIDA SIL-3
/ IBR / PROOF OF DESIGN /
FOOD GRADE / BIS / ISI



Multiport Ball Valve

FUGITIVE EMISSIONS TEST
AS PER ISO 15848-1 / CE /
PED / EIL

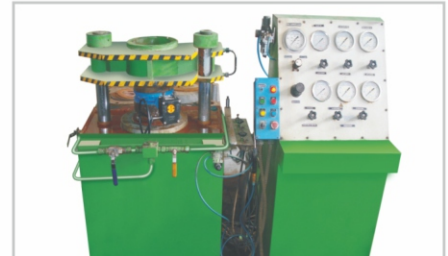
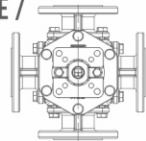

2PC REDUCE BORE EXPLODED BALL VALVE



OPERATING VARIANTS :



MATERIALS :

Item No.	Item Name	Material Name
1	Body	CF8 / CF8M / WCB
2	Connector	CF8 / CF8M / WCB
3	Ball	CF8 / CF8M
4	Ball Seat	PTFE / CFT / GFT
5	Body Seat	PTFE / CFT / GFT
6	Stem Pin	S.S 304 / S.S 316
7	Stem Seat	PTFE / CFT / GFT
8	Gland	CF8 / CF8M / WCB
9	Spacer Ring	S.S. 304 / S.S. 316
10	Gland Bolt & Nut	S.S. 304
11	Fasteners	S.S. 304

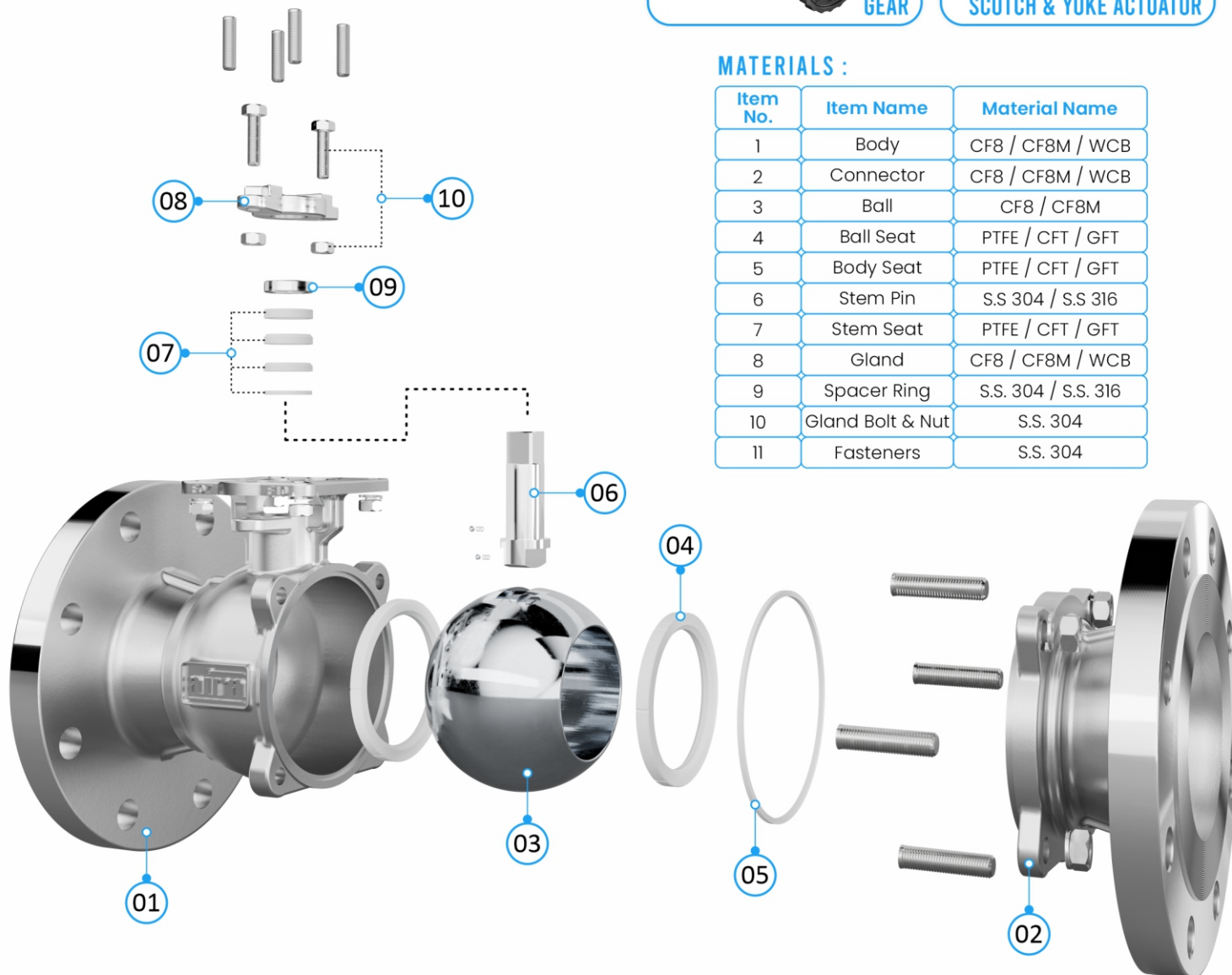

2PC REDUCE BORE BALL VALVE

“aira” Offers Two Piece and Three Piece Design Reduce Bore Ball Valve, Engineered For Multiple On/ Off Operations In The Down Stream.

Standard

- **Design & Manufacturer** : ASME B 16.34 / BS EN ISO 17292
- **Valve Face To Face Dimension** : ASME B 16.10 / BSEN ISO 17292
- **Inspection And Testing** : API 598 / ISO-5208 / BS EN 12266-1
- **Leakage Class** : ISO 5208 Class VI / FCI - 70 - 2 / ASME B 16, 16. 104
(BUBBLE TIGHT SHUTOFF)
- **End Connection** : ASME B 16.5 CLASS 150 FOR FLANGE

Technical Specification

- **Pressure** : 150#
- **Temperature** : PTFE : Upto 180°C
RPTFE / TFM - 220°C

Features

- High Cycle Life.
- Antistatic Design.
- Blowout Proof Stem.
- Locking Handle Available.
- ISO 5211 Mounting Pad Available.

SIZE RANGE 3/4" UPTO 14" FLANGED 150#

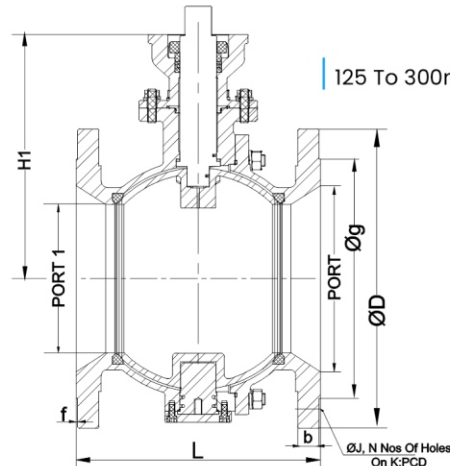
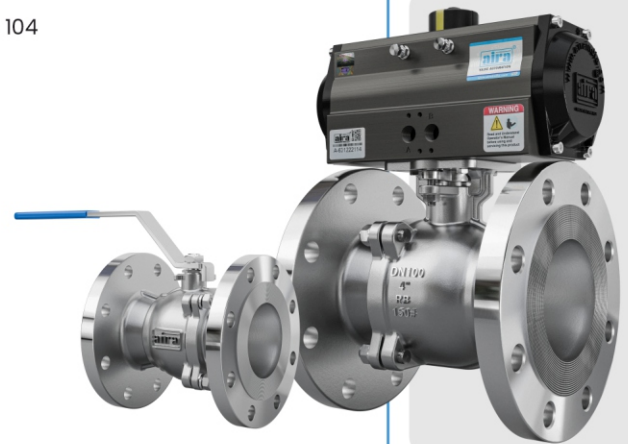

125 To 300mm Design

CE, SIL 3
Approved

Bare Shaft

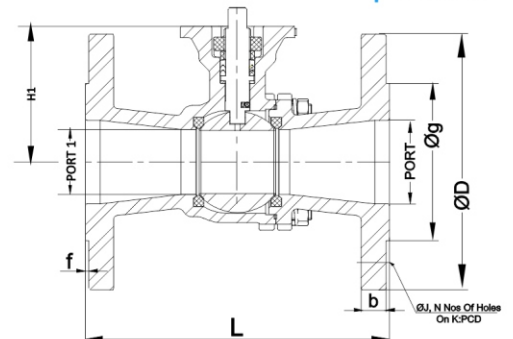

DIMENSIONS													
Valve Size	+3.0 -3.0	+1.0 -0.0	+1.0 -0.0	+2.0 -1.0	+1.0 -1.0	+3.0 -0.0	+0.5 -0.5	ØJ	N	+1.5 -1.5	+5.0 -5.0	+3.0 -3.0	+10.0 -10.0
L-150#	PORT	PORT 1	ØD	Øg	b	f				PCD	H	H1	W
20X15	117	19	13	100	42.9	8.9	2	15.88	4	69.9	66	52	180
25X20	127	25	18	110	50.8	9.6	2	15.88	4	79.4	79	60	195
40X25	165	38	23	125	73	12.7	2	15.88	4	98.4	90	65	250
50X40	178	49	38	150	92.1	14.3	2	19.05	4	120.7	106	80	270
65X50	190	62	49	180	104.8	15.9	2	19.05	4	139.7	120	-	270
80X65	203	74	62	190	127	17.5	2	19.05	4	152.4	141	100	305
100X80	229	100	74	230	157.2	22.3	2	19.05	8	190.5	178	117	355
150X100	267	150	100	280	215.9	23.9	2	22.23	8	241.3	202	144	355
150X125	267	150	123.5	280	215.9	23.9	2	22.23	8	241.3	311	256	321.25
200X150	292	201	147	345	269.9	28	2	22.23	8	298.5	-	281	-
250X200	330	252	201	405	323.8	28.6	2	25.4	12	362	-	331	-

ONLY AVAILABLE IN 3PC :

ON REQUEST													
Valve Size	L-150#	PORT	PORT 1	ØD	Øg	b	f	ØJ	N	PCD	H	H1	W
300X250													
350X300	686	334	303	535	412.8	33.4	2	28.58	12	476.3	-	382	-

*All Dimensions Are In MM

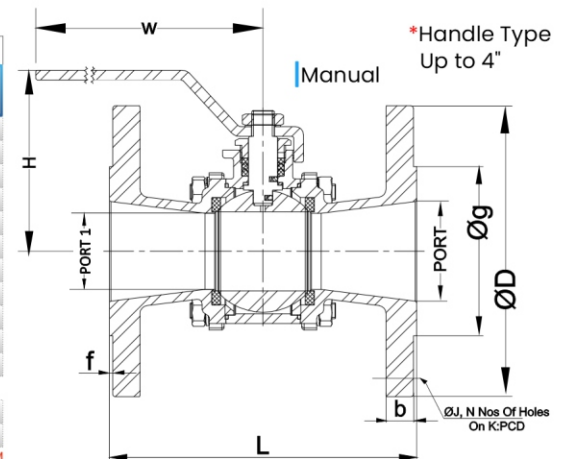



*time tested designs with
superior performance*

GLOBAL Network

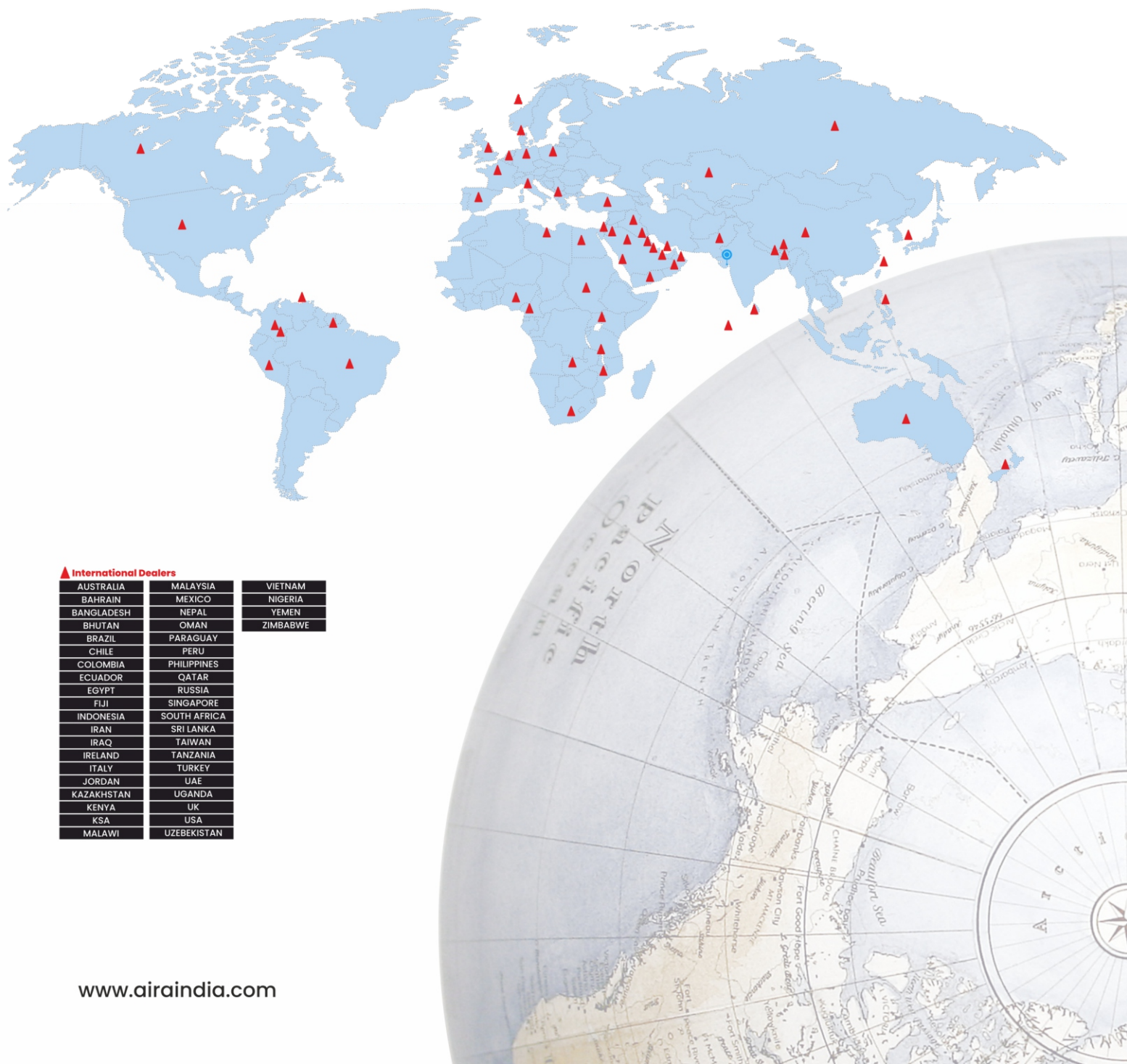

▲ International Dealers

AUSTRALIA	MALAYSIA	VIETNAM
BAHRAIN	MEXICO	NIGERIA
BANGLADESH	NEPAL	YEMEN
BHUTAN	OMAN	ZIMBABWE
BRAZIL	PARAGUAY	
CHILE	PERU	
COLOMBIA	PHILIPPINES	
ECUADOR	QATAR	
EGYPT	RUSSIA	
FIJI	SINGAPORE	
INDONESIA	SOUTH AFRICA	
IRAN	SRI LANKA	
IRAQ	TAIWAN	
IRELAND	TANZANIA	
ITALY	TURKEY	
JORDAN	UAE	
KAZAKHSTAN	UGANDA	
KENYA	UK	
KSA	USA	
MALAWI	UZBEKISTAN	



industrial valve automation

Network

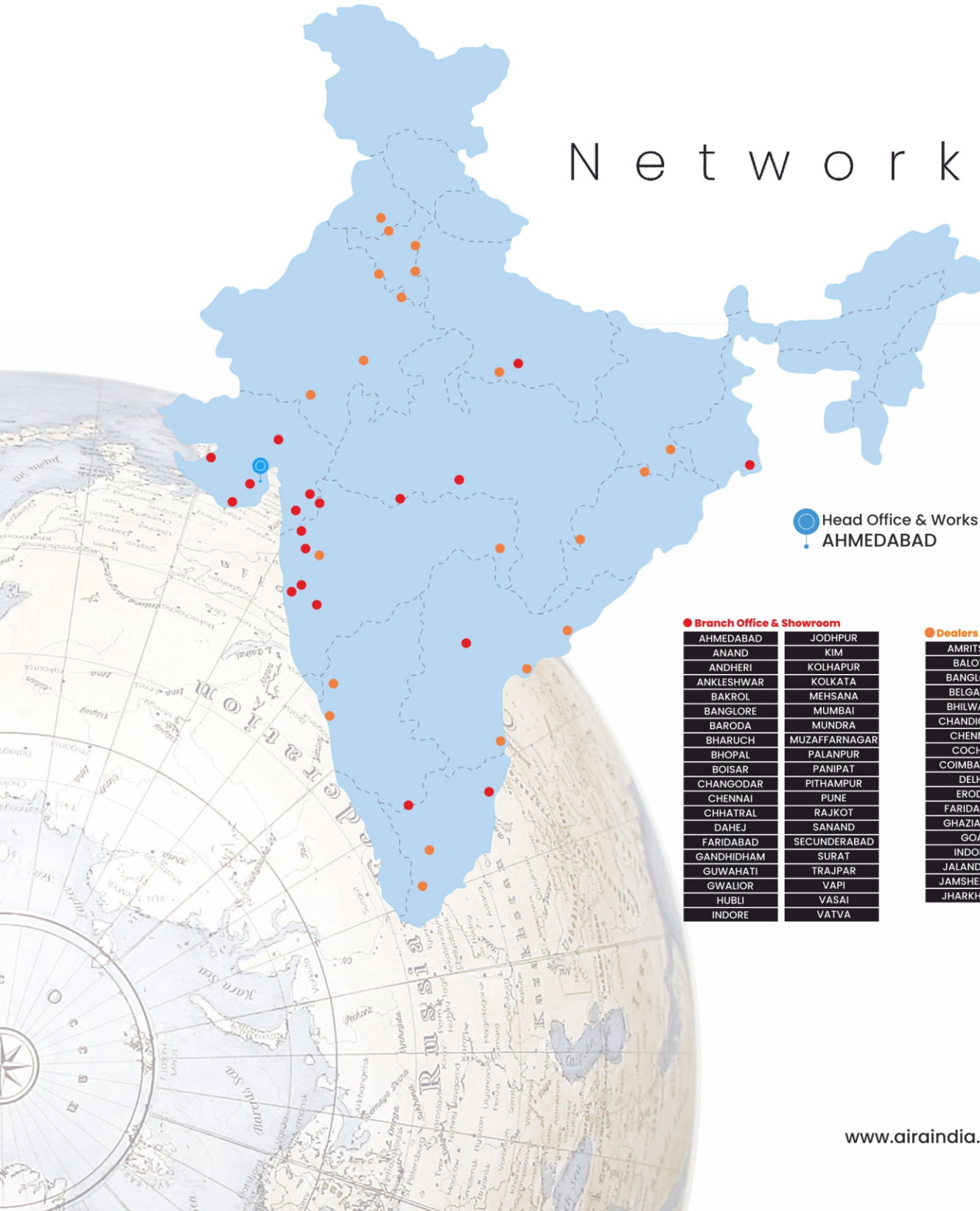

 **Head Office & Works**
AHMEDABAD

● **Branch Office & Showroom**

AHMEDABAD	JODHPUR
ANAND	KIM
ANDHERI	KOLHAPUR
ANKLESHWAR	KOLKATA
BAKROL	MEHSANA
BANGLORE	MUMBAI
BARODA	MUNDRA
BHARUCH	MUZAFFARNAGAR
BHOPAL	PALANPUR
BOISAR	PANIPAT
CHANGODAR	PITHAMPUR
CHENNAI	PUNE
CHHATRAL	RAJKOT
DAHEJ	SANAND
FARIDABAD	SECUNDERABAD
GANDHIDHAM	SURAT
GUWAHATI	TRAJPAR
GWALIOR	VAPI
HUBLI	VASAI
INDORE	VATVA

● **Dealers & Distributors**

AMRITSAR	KOLKATA
BALOTA	LUCKNOW
BANGLORE	LUDHIANA
BELGAUM	MARWAR
BHILWARA	MEERUT
CHANDIGARH	MUZAFFARNAGAR
CHENNAI	NAGPUR
COCHIN	NOIDA
COIMBATORE	PANIPAT
DELHI	PEENYA
ERODE	PUNE
FARIDABAD	TRIPUR
GHAZIABAD	VARANASI
GOA	VISAKHAPATNAM
INDORE	WADI
JALANDHAR	KANPUR
JAMSHEDPUR	KOLHAPUR
JHARKHAND	

2PC REDUCE BORE DESIGN Ball Valve

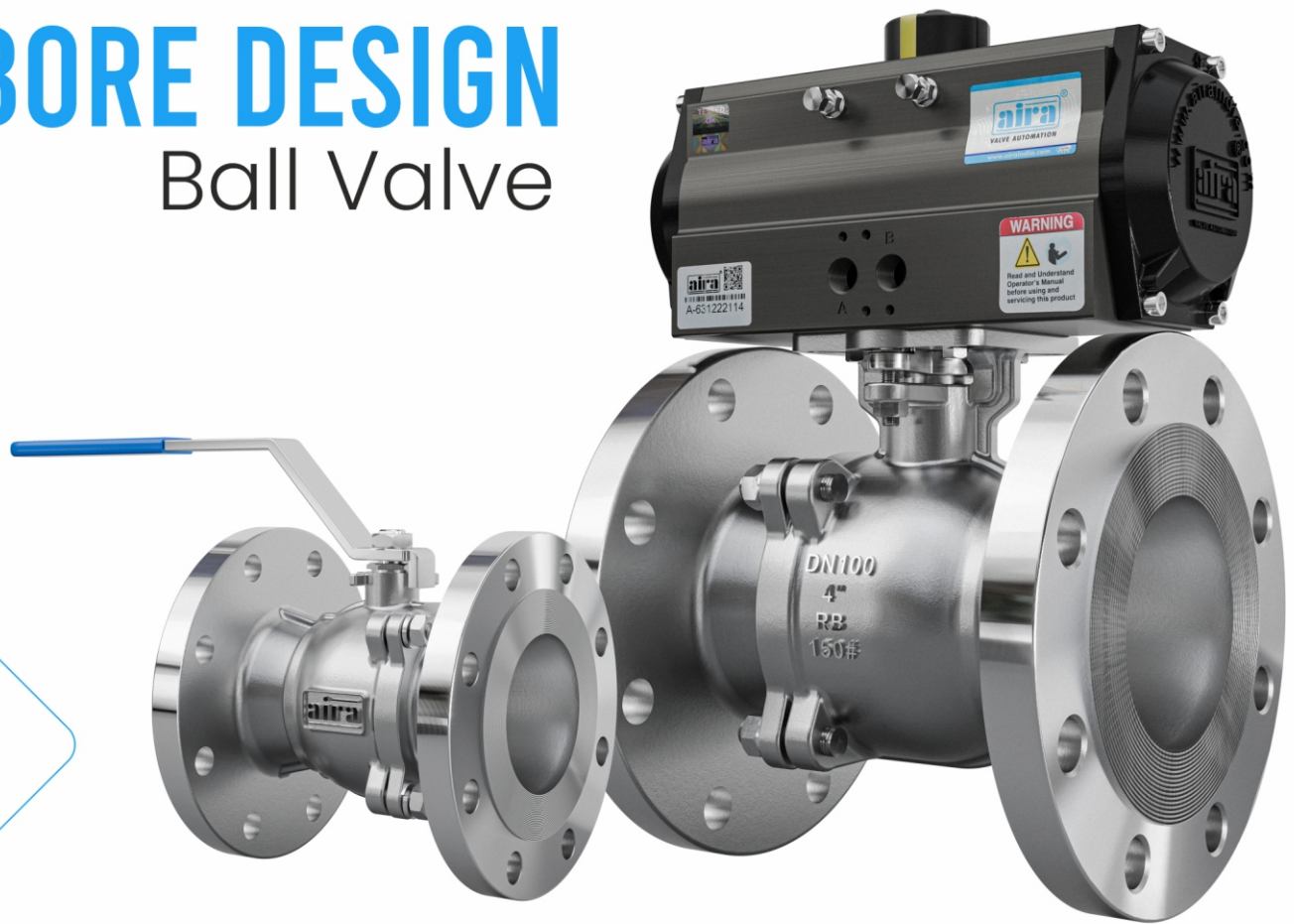

Mfg. & Mkt by :

aira Euro automation pvt. ltd.

Ahmedabad-382405, INDIA.

www.airaindia.com