

YOUR SOLUTION PARTNER IN
INDUSTRIAL
VALVE AUTOMATION...



SINGLE PIECE DESIGN

FLANGED/SCREWED BALL VALVE



APPROVALS



WEBSITE



Mfg. & Mkt by :

aira Euro automation pvt. ltd.

Ahmedabad-382405, INDIA.

www.airaindia.com





About Us

We welcome and thank you for referring out detailed catalogue.

aira is known all over continents as a manufacturer of quality products - Ball Valves, Butterfly Valves, Plug Valves, & Control On / Off Valves with Pneumatic Actuators for Pharma, Oil & Gas, Steel, Paper, Water, Chemical and all type of processing industries.

aira has walked through more than 3 decades, gaining valuable experience, offering equipment's in the products manufactured by OEMs in all spheres of engineering.

aira products have gained reputations of consultants, and approvals of users, OEMs and other as a quality product.

aira has expanding business into foreign markets specially GCC, UAE, Asian & African countries. This is because increase its customer base and revenue, leading to overall growth and success. Now foreign users come to know and believe in the services provided by the **aira**. Along with the same, it also helps to reach a large number of users thereby leading to the increase their business.

Being an ISO 9001 BVQI certified company has put **aira** in fore front. Our motto is "Value the customer" and "Superior product", one among the best in the world.

*Clients are
why we exist!*

Our Quality

- In- House full scale testing facility.
- Lean manufacturing practices
- Certified by : ISO 9001 : 2015 (BVQI LONDON), CE, ATEX, CIMFR, BIS, PESO, SIL 3, IBR
- API 609, API 6D

Our Commitment

- To understand customer's need first before proposing our products.
- To keep on providing competitive rates by adapting to continuous process improvement, without compromising on quality.
- To provide continuous support to our customers and go beyond their expectations in terms of delivery and after sale services.

Our Manufacturing Facility

- In house R & D, manufacturing and testing facility is all located in a spread over three campuses at Ahmedabad, Gujarat, INDIA.

Network - Sales Office

- 60 Plus Branch Offices in different states in India.
- Sales office in the Bangladesh, Dubai, Kenya, Malaysia, Nepal, Qatar, Singapore, South Africa, Sri Lanka, Turkey, USA (Expanding).

CE CERTIFICATE



SIL 3 - BUTTERFLY VALVE



CE - BUTTERFLY VALVE

ISO CERTIFICATIONS



ISO 45001 : 2018



ISO 45001 : 2018



ISO 9001 : 2015



CERTIFICATIONS APPROVALS



QMS (Quality Management System)

ISO 9001 : 2015

EMS (Environment Management System)

ISO 14001 : 2015

OHSAS (Occupational Health & Safety Management System)

ISO 45001 : 2018

IBR
PISTON VALVE
GLOBE CONTROL VALVE (CKD/CND)
DISC CHECK VALVE (DCV)
PRESSURE REDUCING VALVE (PRV)
POP TYPE SAFETY VALVE
BALL VALVE

Pneumatic Actuator

CE /
ATEX /
EXIDA SIL-3 /
PROOF OF DESIGN

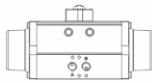

Scotch & Yoke Actuator

CE / ATEX / SIL-3

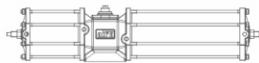

Stainless Steel Actuator

CE /
IEP ATEX

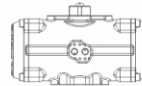

Positioner Enclosure

CE / CIMFR /
IP67 / BIS
/ PESO

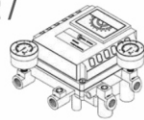

aira's
SOME OF OUR
Certificates

Plug Valve

FUGITIVE EMISSIONS
TEST
AS PER ISO
15848-1 / IBR

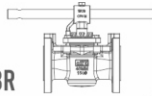

Flameproof Solenoid Valve

IEP ATEX / CE / CIMFR
/ IP65/ IP67 / IP68 /
BIS / PESO

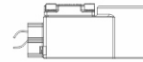

Limit Switch

IEP ATEX / CE / CIMFR
/ IP67 / BIS / PESO /
EQDC IP68

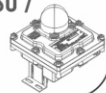

Ball Valve (Floating & Trunnion)

FIRE SAFE TEST DESIGN /
FUGITIVE EMISSIONS TEST
AS PER ISO 15848-1 / CE /
PED /
EXIDA SIL-3

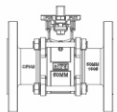

Butterfly Valve (centric / Double & Triple Eccentric)

FIRE SAFE TEST DESIGN /
FUGITIVE EMISSIONS TEST
AS PER ISO 15848-1 / CE /
PED / EXIDA SIL-3
/ IBR / PROOF OF DESIGN /
FOOD GRADE / BIS / ISI



Multiport Ball Valve

FUGITIVE EMISSIONS TEST
AS PER ISO 15848-1 / CE /
PED / EIL

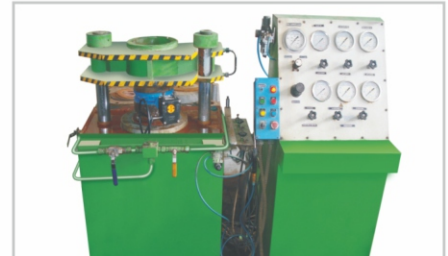
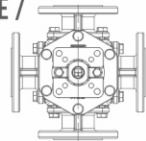

SINGLE PIECE SCREW END EXPLODED BALL VALVE

OPERATING VARIANTS :

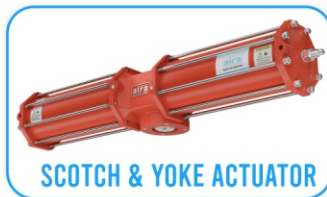

MATERIALS :

Item No.	Item Name	Material Name
1	Body	CF8 / CF8M / WCB
2	Connector	CF8 / CF8M / WCB
3	Ball	S.S. 304 / S.S. 316
4	Stem Pin	S.S. 304 / S.S. 316
5	Ball Seat	PTFE
6	Body Seat	PTFE
7	Stem Seat	PTFE
8	Stem O-Ring	NBR
9	Lock Nut	S.S. 304
10	Fasteners	S.S. 304

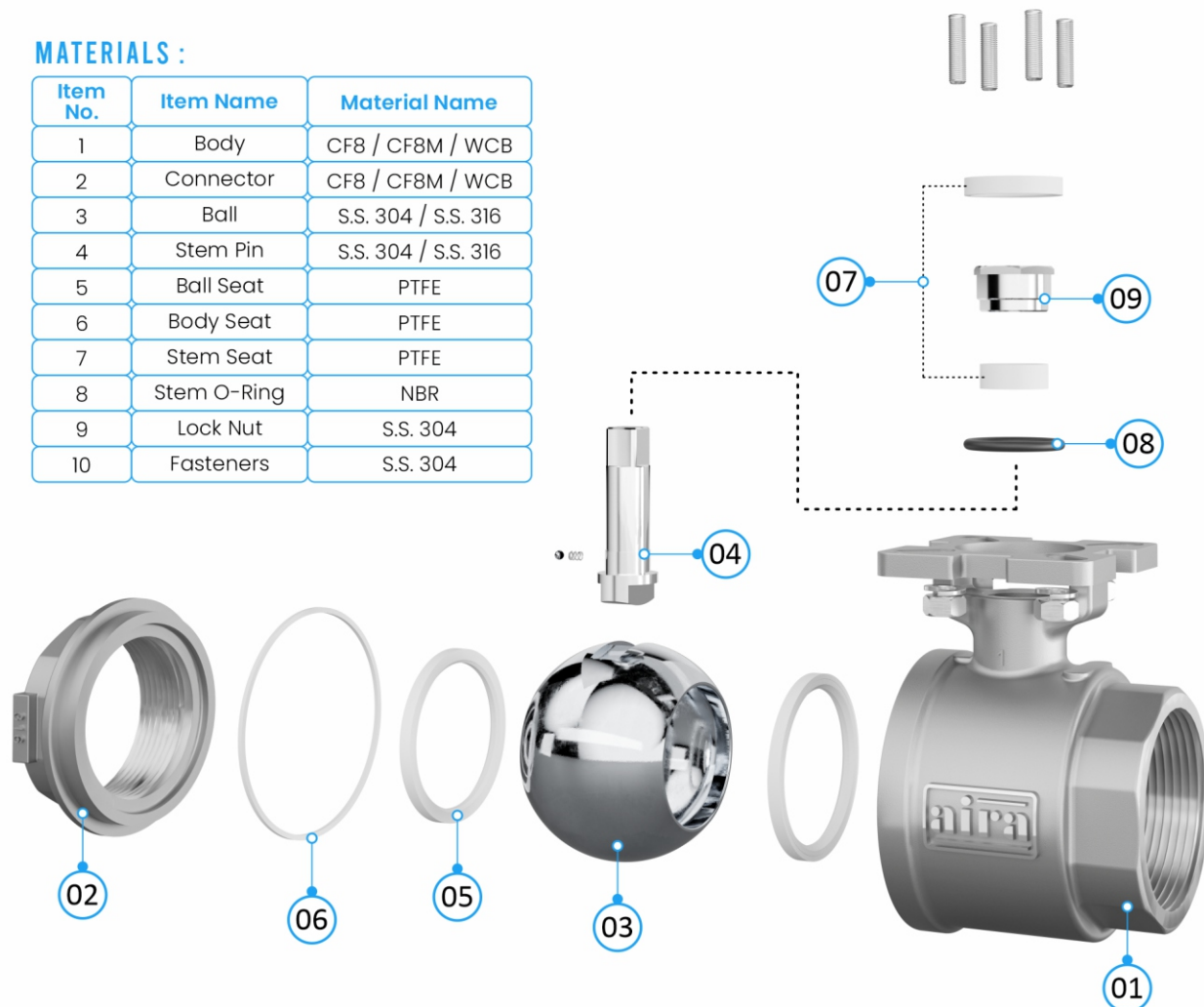

SINGLE PIECE DESIGN SCREW END BALL VALVE

“aira” Offers Automation And Manually Operated Investment Casting WCB / CF8 / CF8M / CF3M Ball Valve Floating In Single Piece Design. Engineered For Multiple On/off Operations In The Down Stream.

Standard

- **Design & Manufacturer** : ASME B 16.34 / BS EN ISO 17292
- **Valve Face To Face Dimension** : ASME B 16.10 / BSEN ISO 17292
- **Inspection And Testing** : API 598 / ISO-5208 / BS EN 12266-1
- **Leakage Class** : ISO 5208 Class VI / FCI - 70 - 2 / ASME B 16, 16. 104
(BUBBLE TIGHT SHUTOFF)
- **End Connection** : ISO 7-1 FOR BSPT / BSP / ASME B 1.201 FOR NPT FOR S/E

Technical Specification

- **Pressure** : 150#
- **Temperature** : PTFE : Upto 180°C
RPTFE / TFM - 220°C

SIZE RANGE 1/4" UPTO 2" SCREWED



Features

- Low Operating Torque.
- One Body Joint Has Less Chance Of Joint Leak.
- Locking Handle Available.

Dimensions :

Valve Size	+3.0 -3.0	TAP	+5.0 -5.0	+3.0 -3.0	+10.0 -10.0
L-150#	H	H1	W		
6 MM	47	1/4"	51	34	87
10 MM	47	3/8"	51	34	87
15 MM	51	1/2"	48	38	87
20 MM	57	3/4"	51	41	93
25 MM	70	1"	68	54	145
32 MM	76	1.1/4"	74	57	115
40 MM	91	1.1/2"	141	68	142
50 MM	95	2"	82	73	142

*All Dimensions Are In MM

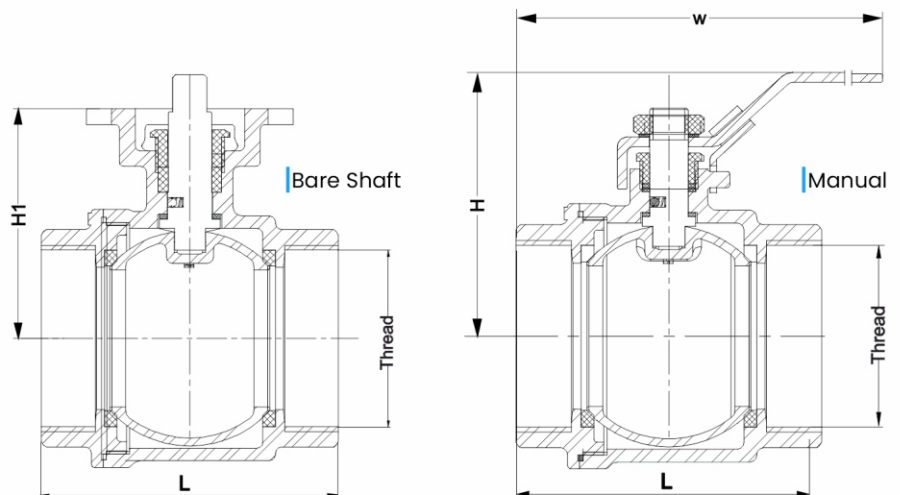

SINGLE PIECE FLANGE END EXPLODED BALL VALVE

OPERATING VARIANTS :

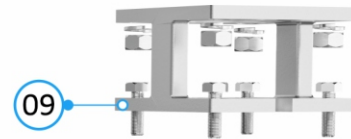
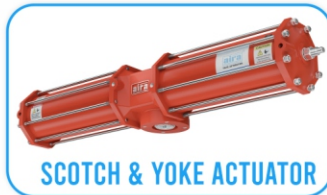

MATERIALS :

Item No.	Item Name	Material Name
1	Body	CF8 / CF8M / WCB
2	Insert	CF8 / CF8M / WCB
3	Ball	CF8 / CF8M
4	Stem Pin	S.S. 304 / S.S. 316
5	Ball Seat	PTFE / CFT / GFT
6	Body Seat	PTFE / CFT / GFT
7	Stem Seat	PTFE / CFT / GFT
8	Spacer Ring	S.S. 304
9	Bracket	S.S. 304
10	Fasteners	S.S. 304

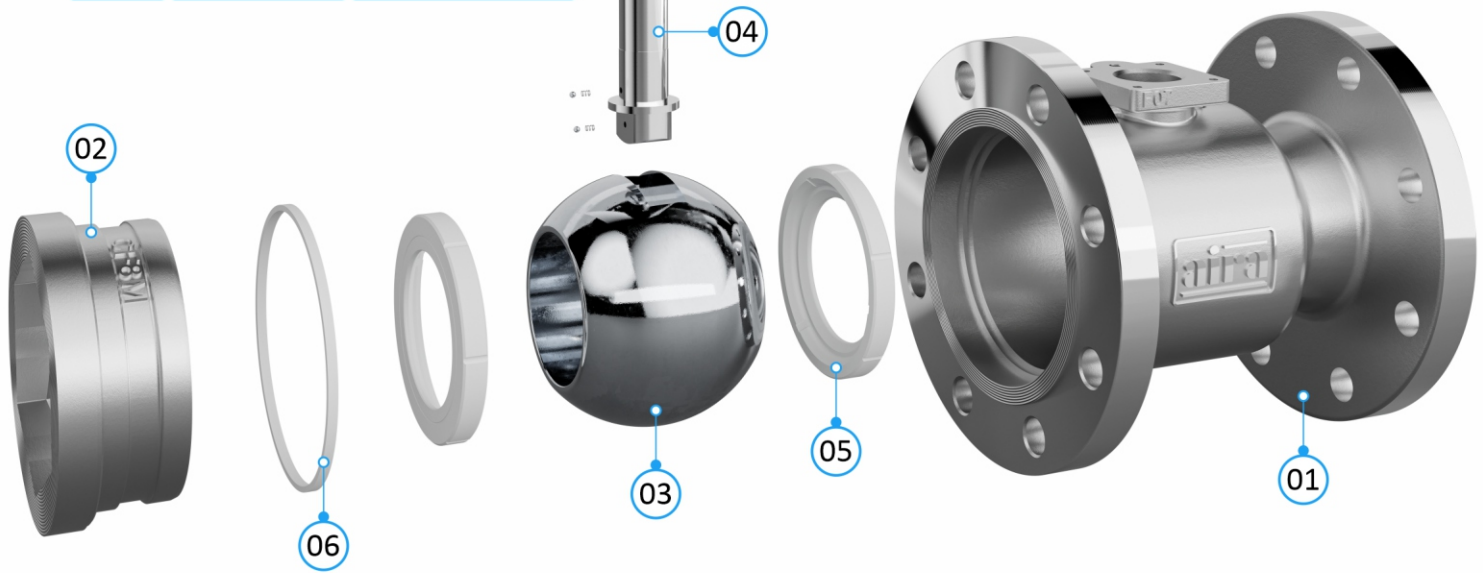

SINGLE PIECE DESIGN FLANGE END BALL VALVE

“aira” Offers Automation And Manually Operated Flanged Ball Valves Feature A Compact, One Piece Body Design With Flanged Insert. The One Piece Body Suppliers Maximum Structural Strength While Minimizing The Number Of Potential Leak Paths. A Floating Ball Design Offers Low Torque And Increase Valve Cycle Life. These Rugged, Economical, End-entry Flanged Ball Valves Are The Ideal Solutions From The “aira” Product Line For Industrial Applications.

SIZE RANGE 1/2" UPTO 6" FLANGED 150#/300#
(REDUCE BORE DESIGN)

Standard

- **Design & Manufacturer** : ASME B 16.34 / BS EN ISO 17292
- **Valve Face To Face Dimension** : ASME B 16.10 - 150# & 300#
- **Inspection And Testing** : API 598 / ISO-5208 / BS EN 12266-1
- **Leakage Class** : ISO 5208 Class VI / B16.104 ,
ANSI FCI 70-2 (BUBBLE TIGHT SHUTOFF)
- **End Connection** : ASME B 16.5 CLASS 150/300 FOR FLANGE END

Technical Specification

- **Pressure** : 150# & 300#
- **Temperature** : PTFE : Upto 180°C / PEEK : 250°C
RPTFE : Upto 220°C / AIRA250

Features

- Low Operating Torque.
- Positive Shut Off.
- Quick In Action.
- Compact Design.
- Longer Smooth Life.
- Locking Handle Available.



65 To 100mm Design

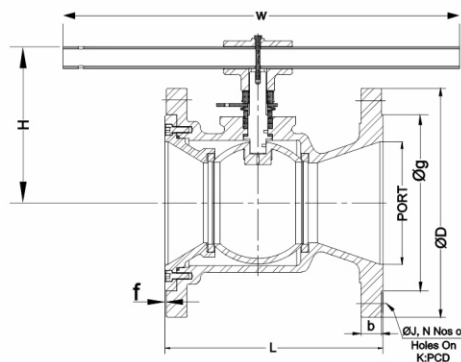

150#

Valve Size	+3.0 -3.0 L-150#	+1.0 -0.0 PORT	+2.0 -1.0 ØD	+1.0 -1.0 Øg	+3.0 -0.0 b	+0.5 -0.5 f	ØJ	N	+1.5 -1.5 PCD	+5.0 -5.0 H	+3.0 -3.0 HI	+10.0 -10.0 W
15 MM	108	13	90	34.9	8	2	15.88	4	60.3	92	48	121
20 MM	117	19	100	42.9	8.9	2	15.88	4	69.9	92	58	121
25 MM	127	25	110	50.8	9.6	2	15.88	4	79.4	98	64	138
40 MM	165	38	125	73	12.7	2	15.88	4	98.4	85	69	209
50 MM	178	49	150	92.1	14.3	2	19.05	4	120.7	110	82	270
65 MM	190	62	180	104.8	15.9	2	19.05	4	139.7	152	128	285
80 MM	203	74	190	127	17.5	2	19.05	4	152.4	162	134	390
100 MM	229	100	230	157.2	22.3	2	19.05	8	190.5	173	145	390
150 MM	267	150	280	215.9	23.9	2	22.23	8	241.3	-	-	-

300#

Valve Size	+3.0 -3.0 L-300#	+1.0 -0.0 PORT	+2.0 -1.0 ØD	+1.0 -1.0 Øg	+3.0 -0.0 b	+0.5 -0.5 f	ØJ	N	+1.5 -1.5 PCD	+5.0 -5.0 H	+3.0 -3.0 HI	+10.0 -10.0 W
15 MM	140	13	95	34.9	12.7	2	15.88	4	66.7	82	-	212
20 MM	152	19	115	42.9	14.3	2	19.05	4	82.6	82	-	221
25 MM	165	25	125	50.8	15.9	2	19.05	4	88.9	91	-	138
40 MM	190	38	155	73	19.1	2	22.23	4	114.3	99	-	227
50 MM	216	49	165	92.1	20.7	2	19.05	8	127	111	-	227
65 MM	241	62	190	104.8	23.9	2	22.23	8	149.2	161	-	470
80 MM	282	74	210	127	27	2	22.23	8	168.3	185	-	470
100 MM	305	100	255	157.2	30.2	2	22.23	8	200	214	-	449
150 MM	403	150	320	215.9	35	2	22.23	12	269.9	204	-	600

*All Dimensions Are In MM

*Handle Type
Up to 4"

Manual

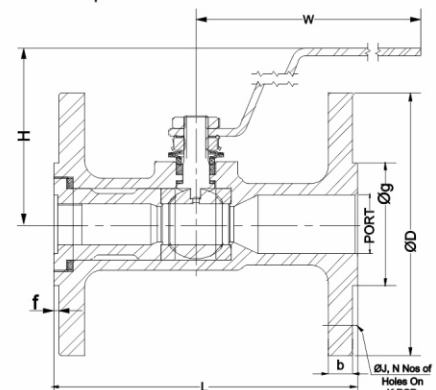

Bare Shaft

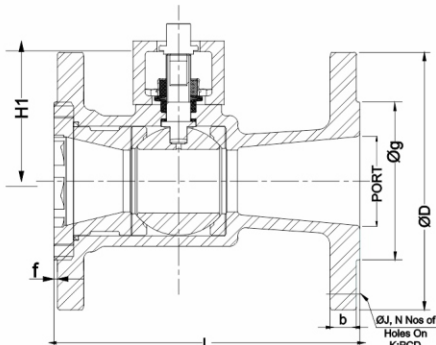



*time tested designs with
superior performance*

GLOBAL Network



▲ International Dealers

AUSTRALIA	MALAYSIA	VIETNAM
BAHRAIN	MEXICO	NIGERIA
BANGLADESH	NEPAL	YEMEN
BHUTAN	OMAN	ZIMBABWE
BRAZIL	PARAGUAY	
CHILE	PERU	
COLOMBIA	PHILIPPINES	
ECUADOR	QATAR	
EGYPT	RUSSIA	
FIJI	SINGAPORE	
INDONESIA	SOUTH AFRICA	
IRAN	SRI LANKA	
IRAQ	TAIWAN	
IRELAND	TANZANIA	
ITALY	TURKEY	
JORDAN	UAE	
KAZAKHSTAN	UGANDA	
KENYA	UK	
KSA	USA	
MALAWI	UZBEKISTAN	



industrial valve automation

Network

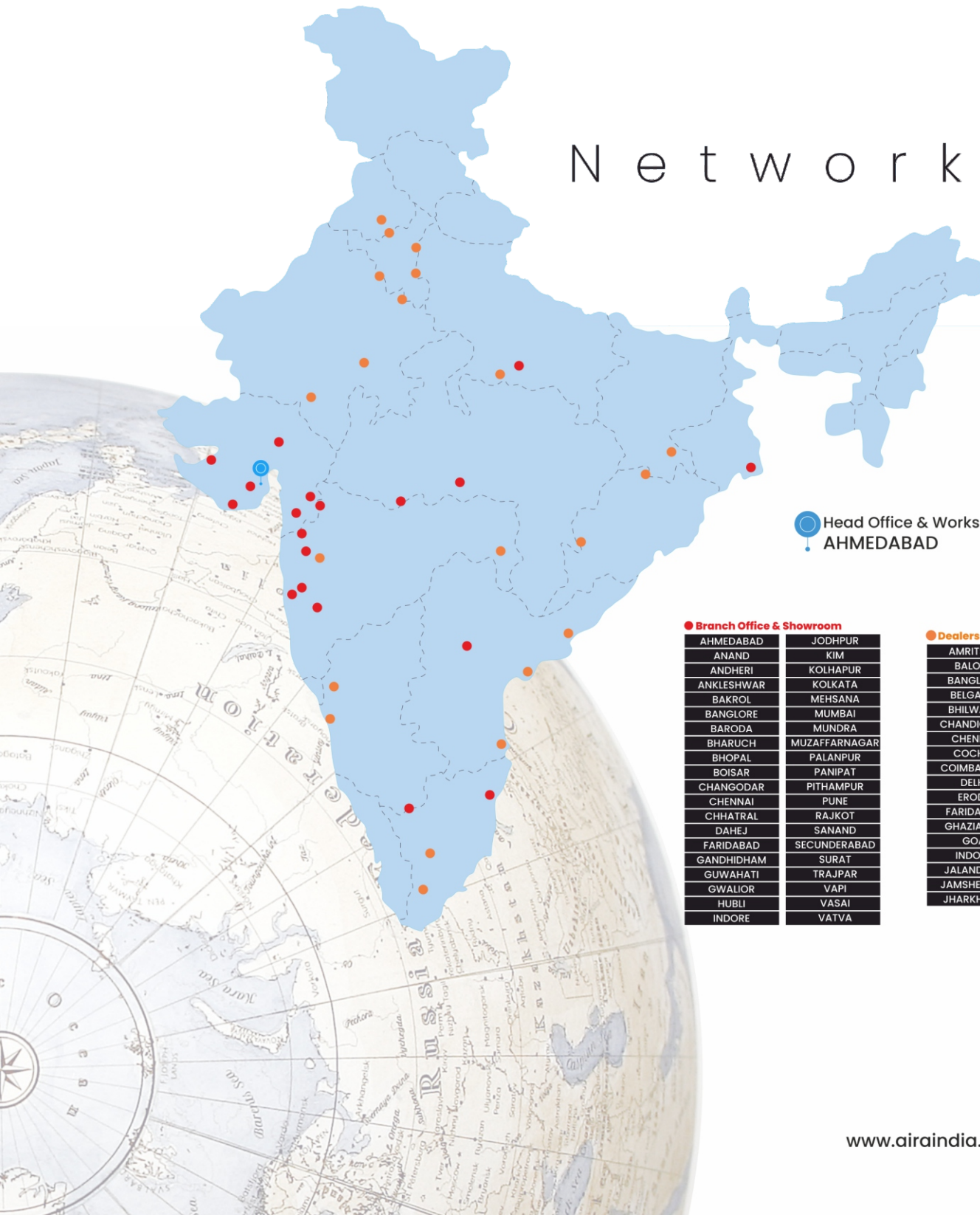

Head Office & Works
AHMEDABAD

● Branch Office & Showroom

AHMEDABAD	JODHPUR
ANAND	KIM
ANDHERI	KOLHAPUR
ANKLESHWAR	KOLKATA
BAKROL	MEHSANA
BANGLORE	MUMBAI
BARODA	MUNDRA
BHARUCH	MUZAFFARNAGAR
BHOPAL	PALANPUR
BOISAR	PANIPAT
CHANGODAR	PITHAMPUR
CHENNAI	PUNE
CHHATRAL	RAJKOT
DAHEJ	SANAND
FARIDABAD	SECUNDERABAD
GANDHIDHAM	SURAT
GUWAHATI	TRAJPAR
GWALIOR	VAPI
HUBLI	VASAI
INDORE	VATVA

● Dealers & Distributors

AMRITSAR	KOLKATA
BALOTA	LUCKNOW
BANGLORE	LUDHIANA
BELGAUM	MARWAR
BHILWARA	MEERUT
CHANDIGARH	MUZAFFARNAGAR
CHENNAI	NAGPUR
COCHIN	NOIDA
COIMBATORE	PANIPAT
DELHI	PEENYA
ERODE	PUNE
FARIDABAD	TRIPUR
GHAZIABAD	VARANASI
GOA	VISAKHAPATNAM
INDORE	WADI
JALANDHAR	KANPUR
JAMSHEDPUR	KOLHAPUR
JHARKHAND	

SINGLE PIECE DESIGN

Ball Valve

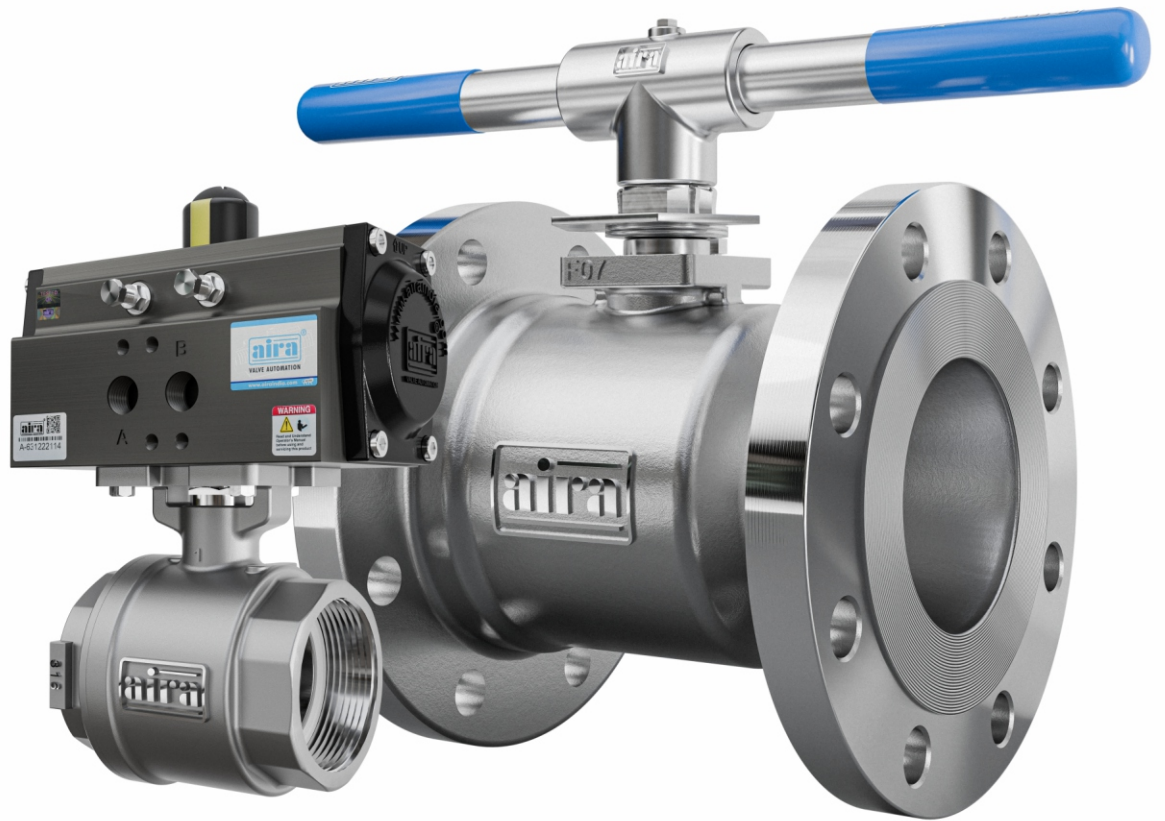

Mfg. & Mkt by :

aira Euro automation pvt. ltd.

Ahmedabad-382405, INDIA.

www.airaindia.com

