

YOUR SOLUTION PARTNER IN
INDUSTRIAL
VALVE AUTOMATION...

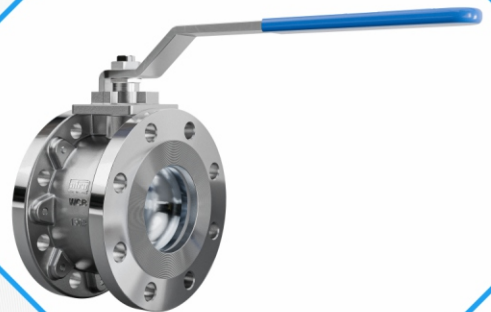

WAFER TYPE DESIGN FLANGED BALL VALVE



APPROVALS



WEBSITE



Mfg. & Mkt by :

aira Euro automation pvt. ltd.

Ahmedabad-382405, INDIA.

www.airaindia.com





About Us

We welcome and thank you for referring out detailed catalogue.

aira is known all over continents as a manufacturer of quality products - Ball Valves, Butterfly Valves, Plug Valves, & Control On / Off Valves with Pneumatic Actuators for Pharma, Oil & Gas, Steel, Paper, Water, Chemical and all type of processing industries.

aira has walked through more than 3 decades, gaining valuable experience, offering equipment's in the products manufactured by OEMs in all spheres of engineering.

aira products have gained reputations of consultants, and approvals of users, OEMs and other as a quality product.

aira has expanding business into foreign markets specially GCC, UAE, Asian & African countries. This is because increase its customer base and revenue, leading to overall growth and success. Now foreign users come to know and believe in the services provided by the **aira**. Along with the same, it also helps to reach a large number of users thereby leading to the increase their business.

Being an ISO 9001 BVQI certified company has put **aira** in fore front. Our motto is "Value the customer" and "Superior product", one among the best in the world.

*Clients are
why we exist!*

Our Quality

- In- House full scale testing facility.
- Lean manufacturing practices
- Certified by : ISO 9001 : 2015 (BVQI LONDON), CE, ATEX, CIMFR, BIS, PESO, SIL 3, IBR
- API 609, API 6D

Our Commitment

- To understand customer's need first before proposing our products.
- To keep on providing competitive rates by adapting to continuous process improvement, without compromising on quality.
- To provide continuous support to our customers and go beyond their expectations in terms of delivery and after sale services.

Our Manufacturing Facility

- In house R & D, manufacturing and testing facility is all located in a spread over three campuses at Ahmedabad, Gujarat, INDIA.

Network - Sales Office

- 60 Plus Branch Offices in different states in India.
- Sales office in the Bangladesh, Dubai, Kenya, Malaysia, Nepal, Qatar, Singapore, South Africa, Sri Lanka, Turkey, USA (Expanding).

SIL 3 CERTIFICATIONS

CE CERTIFICATE



**Certificate / Certificat
Zertifikat / 合格証**
AEA 1902082 C001
exida hereby confirms that the:

**Pneumatic Rotary Actuator
Aira Euro Automation Pvt Ltd
Ahmedabad - India**

Has been assessed per the relevant requirements of:
IEC 61508 : 2010 Parts 1-7
and meets requirements providing a level of integrity to:
Systematic Capability: SC 3 (SIL 3 Capable)
**Random Capability: Type A, Route 2, Device
PFH/PFD₀ and Architecture Constraints
must be verified for each application**

Safety Function:
The Actuator will move the attached Valve to the designed safe position per the Actuator design within the specified safety time.

Application Restrictions:
The unit must be properly designed into a Safety Instrumented Function per the Safety Manual requirements.

Revision: 1.0 Dec 24, 2019
Surveillance Audit Due: Jan 01, 2023

Evaluating Assessor
[Signature]
Certifying Assessor
[Signature]

IAF ANSI
RECOGNIZED PRODUCT CERTIFICATION BODY

SIL 3 - PNEUMATIC ROTARY ACTUATORS



**Certificate / Certificat
Zertifikat / 合格証**
AEA 1902082 C002
exida hereby confirms that the:

**Double Eccentric Butterfly Valve
Aira Euro Automation Pvt Ltd
Ahmedabad - India**

Has been assessed per the relevant requirements of:
IEC 61508 : 2010 Parts 1-7
and meets requirements providing a level of integrity to:
Systematic Capability: SC 3 (SIL 3 Capable)
**Random Capability: Type A, Route 2, Device
PFH/PFD₀ and Architecture Constraints
must be verified for each application**

Safety Function:
The Butterfly Valve will move to the designed safe position per the actuator design within the specified safety time.

Application Restrictions:
The unit must be properly designed into a Safety Instrumented Function per the Safety Manual requirements.

Revision: 1.0 Dec 24, 2019
Surveillance Audit Due: Jan 01, 2023

Evaluating Assessor
[Signature]
Certifying Assessor
[Signature]

IAF ANSI
RECOGNIZED PRODUCT CERTIFICATION BODY

Page 1 of 2

SIL 3 - BUTTERFLY VALVE



**CERTIFICATE OF FULL QUALITY
ASSURANCE FOR
PRESSURE EQUIPMENT
ACCORDING TO
EUROPEAN DIRECTIVE
2014/68/EU (MODULE H)**

Certificate No: 18-07-11886
Date of issue: 03/04/2021
Valid from: 03/04/2021
The Certificate is valid until: 03/04/2024
Subject to satisfactory annual surveillance

Approved Manufacturer: AIRA EURO AUTOMATION PVT. LTD.
PLOT NO. 123-124, AIRA ESTATE, NEAR KASHIMATH TEXTILE MILL, AHMEDABAD, GUJARAT, INDIA.
Product: BUTTERFLY VALVE

Type of Pressure Equipment: Access to this certificate

Technical Description of Pressure Equipment: Access to this certificate

Product Category of Pressure Equipment: 01

Against the Provisions of: EUROPEAN PRESSURE EQUIPMENT DIRECTIVE 2014/68/EU, ANNEX I, PART II, SECTION 1, SUBSECTION 1.2, 1.3, 1.4, 1.5, 1.6, 1.7, 1.8, 1.9, 2.0, 2.1, 2.2, 2.3, 2.4, 2.5, 2.6, 2.7, 2.8, 2.9, 3.0, 3.1, 3.2, 3.3, 3.4, 3.5, 3.6, 3.7, 3.8, 3.9, 4.0, 4.1, 4.2, 4.3, 4.4, 4.5, 4.6, 4.7, 4.8, 4.9, 5.0, 5.1, 5.2, 5.3, 5.4, 5.5, 5.6, 5.7, 5.8, 5.9, 6.0, 6.1, 6.2, 6.3, 6.4, 6.5, 6.6, 6.7, 6.8, 6.9, 7.0, 7.1, 7.2, 7.3, 7.4, 7.5, 7.6, 7.7, 7.8, 7.9, 8.0, 8.1, 8.2, 8.3, 8.4, 8.5, 8.6, 8.7, 8.8, 8.9, 9.0, 9.1, 9.2, 9.3, 9.4, 9.5, 9.6, 9.7, 9.8, 9.9, 10.0, 10.1, 10.2, 10.3, 10.4, 10.5, 10.6, 10.7, 10.8, 10.9, 11.0, 11.1, 11.2, 11.3, 11.4, 11.5, 11.6, 11.7, 11.8, 11.9, 12.0, 12.1, 12.2, 12.3, 12.4, 12.5, 12.6, 12.7, 12.8, 12.9, 13.0, 13.1, 13.2, 13.3, 13.4, 13.5, 13.6, 13.7, 13.8, 13.9, 14.0, 14.1, 14.2, 14.3, 14.4, 14.5, 14.6, 14.7, 14.8, 14.9, 15.0, 15.1, 15.2, 15.3, 15.4, 15.5, 15.6, 15.7, 15.8, 15.9, 16.0, 16.1, 16.2, 16.3, 16.4, 16.5, 16.6, 16.7, 16.8, 16.9, 17.0, 17.1, 17.2, 17.3, 17.4, 17.5, 17.6, 17.7, 17.8, 17.9, 18.0, 18.1, 18.2, 18.3, 18.4, 18.5, 18.6, 18.7, 18.8, 18.9, 19.0, 19.1, 19.2, 19.3, 19.4, 19.5, 19.6, 19.7, 19.8, 19.9, 20.0, 20.1, 20.2, 20.3, 20.4, 20.5, 20.6, 20.7, 20.8, 20.9, 21.0, 21.1, 21.2, 21.3, 21.4, 21.5, 21.6, 21.7, 21.8, 21.9, 22.0, 22.1, 22.2, 22.3, 22.4, 22.5, 22.6, 22.7, 22.8, 22.9, 23.0, 23.1, 23.2, 23.3, 23.4, 23.5, 23.6, 23.7, 23.8, 23.9, 24.0, 24.1, 24.2, 24.3, 24.4, 24.5, 24.6, 24.7, 24.8, 24.9, 25.0, 25.1, 25.2, 25.3, 25.4, 25.5, 25.6, 25.7, 25.8, 25.9, 26.0, 26.1, 26.2, 26.3, 26.4, 26.5, 26.6, 26.7, 26.8, 26.9, 27.0, 27.1, 27.2, 27.3, 27.4, 27.5, 27.6, 27.7, 27.8, 27.9, 28.0, 28.1, 28.2, 28.3, 28.4, 28.5, 28.6, 28.7, 28.8, 28.9, 29.0, 29.1, 29.2, 29.3, 29.4, 29.5, 29.6, 29.7, 29.8, 29.9, 30.0, 30.1, 30.2, 30.3, 30.4, 30.5, 30.6, 30.7, 30.8, 30.9, 31.0, 31.1, 31.2, 31.3, 31.4, 31.5, 31.6, 31.7, 31.8, 31.9, 32.0, 32.1, 32.2, 32.3, 32.4, 32.5, 32.6, 32.7, 32.8, 32.9, 33.0, 33.1, 33.2, 33.3, 33.4, 33.5, 33.6, 33.7, 33.8, 33.9, 34.0, 34.1, 34.2, 34.3, 34.4, 34.5, 34.6, 34.7, 34.8, 34.9, 35.0, 35.1, 35.2, 35.3, 35.4, 35.5, 35.6, 35.7, 35.8, 35.9, 36.0, 36.1, 36.2, 36.3, 36.4, 36.5, 36.6, 36.7, 36.8, 36.9, 37.0, 37.1, 37.2, 37.3, 37.4, 37.5, 37.6, 37.7, 37.8, 37.9, 38.0, 38.1, 38.2, 38.3, 38.4, 38.5, 38.6, 38.7, 38.8, 38.9, 39.0, 39.1, 39.2, 39.3, 39.4, 39.5, 39.6, 39.7, 39.8, 39.9, 40.0, 40.1, 40.2, 40.3, 40.4, 40.5, 40.6, 40.7, 40.8, 40.9, 41.0, 41.1, 41.2, 41.3, 41.4, 41.5, 41.6, 41.7, 41.8, 41.9, 42.0, 42.1, 42.2, 42.3, 42.4, 42.5, 42.6, 42.7, 42.8, 42.9, 43.0, 43.1, 43.2, 43.3, 43.4, 43.5, 43.6, 43.7, 43.8, 43.9, 44.0, 44.1, 44.2, 44.3, 44.4, 44.5, 44.6, 44.7, 44.8, 44.9, 45.0, 45.1, 45.2, 45.3, 45.4, 45.5, 45.6, 45.7, 45.8, 45.9, 46.0, 46.1, 46.2, 46.3, 46.4, 46.5, 46.6, 46.7, 46.8, 46.9, 47.0, 47.1, 47.2, 47.3, 47.4, 47.5, 47.6, 47.7, 47.8, 47.9, 48.0, 48.1, 48.2, 48.3, 48.4, 48.5, 48.6, 48.7, 48.8, 48.9, 49.0, 49.1, 49.2, 49.3, 49.4, 49.5, 49.6, 49.7, 49.8, 49.9, 50.0, 50.1, 50.2, 50.3, 50.4, 50.5, 50.6, 50.7, 50.8, 50.9, 51.0, 51.1, 51.2, 51.3, 51.4, 51.5, 51.6, 51.7, 51.8, 51.9, 52.0, 52.1, 52.2, 52.3, 52.4, 52.5, 52.6, 52.7, 52.8, 52.9, 53.0, 53.1, 53.2, 53.3, 53.4, 53.5, 53.6, 53.7, 53.8, 53.9, 54.0, 54.1, 54.2, 54.3, 54.4, 54.5, 54.6, 54.7, 54.8, 54.9, 55.0, 55.1, 55.2, 55.3, 55.4, 55.5, 55.6, 55.7, 55.8, 55.9, 56.0, 56.1, 56.2, 56.3, 56.4, 56.5, 56.6, 56.7, 56.8, 56.9, 57.0, 57.1, 57.2, 57.3, 57.4, 57.5, 57.6, 57.7, 57.8, 57.9, 58.0, 58.1, 58.2, 58.3, 58.4, 58.5, 58.6, 58.7, 58.8, 58.9, 59.0, 59.1, 59.2, 59.3, 59.4, 59.5, 59.6, 59.7, 59.8, 59.9, 60.0, 60.1, 60.2, 60.3, 60.4, 60.5, 60.6, 60.7, 60.8, 60.9, 61.0, 61.1, 61.2, 61.3, 61.4, 61.5, 61.6, 61.7, 61.8, 61.9, 62.0, 62.1, 62.2, 62.3, 62.4, 62.5, 62.6, 62.7, 62.8, 62.9, 63.0, 63.1, 63.2, 63.3, 63.4, 63.5, 63.6, 63.7, 63.8, 63.9, 64.0, 64.1, 64.2, 64.3, 64.4, 64.5, 64.6, 64.7, 64.8, 64.9, 65.0, 65.1, 65.2, 65.3, 65.4, 65.5, 65.6, 65.7, 65.8, 65.9, 66.0, 66.1, 66.2, 66.3, 66.4, 66.5, 66.6, 66.7, 66.8, 66.9, 67.0, 67.1, 67.2, 67.3, 67.4, 67.5, 67.6, 67.7, 67.8, 67.9, 68.0, 68.1, 68.2, 68.3, 68.4, 68.5, 68.6, 68.7, 68.8, 68.9, 69.0, 69.1, 69.2, 69.3, 69.4, 69.5, 69.6, 69.7, 69.8, 69.9, 70.0, 70.1, 70.2, 70.3, 70.4, 70.5, 70.6, 70.7, 70.8, 70.9, 71.0, 71.1, 71.2, 71.3, 71.4, 71.5, 71.6, 71.7, 71.8, 71.9, 72.0, 72.1, 72.2, 72.3, 72.4, 72.5, 72.6, 72.7, 72.8, 72.9, 73.0, 73.1, 73.2, 73.3, 73.4, 73.5, 73.6, 73.7, 73.8, 73.9, 74.0, 74.1, 74.2, 74.3, 74.4, 74.5, 74.6, 74.7, 74.8, 74.9, 75.0, 75.1, 75.2, 75.3, 75.4, 75.5, 75.6, 75.7, 75.8, 75.9, 76.0, 76.1, 76.2, 76.3, 76.4, 76.5, 76.6, 76.7, 76.8, 76.9, 77.0, 77.1, 77.2, 77.3, 77.4, 77.5, 77.6, 77.7, 77.8, 77.9, 78.0, 78.1, 78.2, 78.3, 78.4, 78.5, 78.6, 78.7, 78.8, 78.9, 79.0, 79.1, 79.2, 79.3, 79.4, 79.5, 79.6, 79.7, 79.8, 79.9, 80.0, 80.1, 80.2, 80.3, 80.4, 80.5, 80.6, 80.7, 80.8, 80.9, 81.0, 81.1, 81.2, 81.3, 81.4, 81.5, 81.6, 81.7, 81.8, 81.9, 82.0, 82.1, 82.2, 82.3, 82.4, 82.5, 82.6, 82.7, 82.8, 82.9, 83.0, 83.1, 83.2, 83.3, 83.4, 83.5, 83.6, 83.7, 83.8, 83.9, 84.0, 84.1, 84.2, 84.3, 84.4, 84.5, 84.6, 84.7, 84.8, 84.9, 85.0, 85.1, 85.2, 85.3, 85.4, 85.5, 85.6, 85.7, 85.8, 85.9, 86.0, 86.1, 86.2, 86.3, 86.4, 86.5, 86.6, 86.7, 86.8, 86.9, 87.0, 87.1, 87.2, 87.3, 87.4, 87.5, 87.6, 87.7, 87.8, 87.9, 88.0, 88.1, 88.2, 88.3, 88.4, 88.5, 88.6, 88.7, 88.8, 88.9, 89.0, 89.1, 89.2, 89.3, 89.4, 89.5, 89.6, 89.7, 89.8, 89.9, 90.0, 90.1, 90.2, 90.3, 90.4, 90.5, 90.6, 90.7, 90.8, 90.9, 91.0, 91.1, 91.2, 91.3, 91.4, 91.5, 91.6, 91.7, 91.8, 91.9, 92.0, 92.1, 92.2, 92.3, 92.4, 92.5, 92.6, 92.7, 92.8, 92.9, 93.0, 93.1, 93.2, 93.3, 93.4, 93.5, 93.6, 93.7, 93.8, 93.9, 94.0, 94.1, 94.2, 94.3, 94.4, 94.5, 94.6, 94.7, 94.8, 94.9, 95.0, 95.1, 95.2, 95.3, 95.4, 95.5, 95.6, 95.7, 95.8, 95.9, 96.0, 96.1, 96.2, 96.3, 96.4, 96.5, 96.6, 96.7, 96.8, 96.9, 97.0, 97.1, 97.2, 97.3, 97.4, 97.5, 97.6, 97.7, 97.8, 97.9, 98.0, 98.1, 98.2, 98.3, 98.4, 98.5, 98.6, 98.7, 98.8, 98.9, 99.0, 99.1, 99.2, 99.3, 99.4, 99.5, 99.6, 99.7, 99.8, 99.9, 100.0, 100.1, 100.2, 100.3, 100.4, 100.5, 100.6, 100.7, 100.8, 100.9, 101.0, 101.1, 101.2, 101.3, 101.4, 101.5, 101.6, 101.7, 101.8, 101.9, 102.0, 102.1, 102.2, 102.3, 102.4, 102.5, 102.6, 102.7, 102.8, 102.9, 103.0, 103.1, 103.2, 103.3, 103.4, 103.5, 103.6, 103.7, 103.8, 103.9, 104.0, 104.1, 104.2, 104.3, 104.4, 104.5, 104.6, 104.7, 104.8, 104.9, 105.0, 105.1, 105.2, 105.3, 105.4, 105.5, 105.6, 105.7, 105.8, 105.9, 106.0, 106.1, 106.2, 106.3, 106.4, 106.5, 106.6, 106.7, 106.8, 106.9, 107.0, 107.1, 107.2, 107.3, 107.4, 107.5, 107.6, 107.7, 107.8, 107.9, 108.0, 108.1, 108.2, 108.3, 108.4, 108.5, 108.6, 108.7, 108.8, 108.9, 109.0, 109.1, 109.2, 109.3, 109.4, 109.5, 109.6, 109.7, 109.8, 109.9, 110.0, 110.1, 110.2, 110.3, 110.4, 110.5, 110.6, 110.7, 110.8, 110.9, 111.0, 111.1, 111.2, 111.3, 111.4, 111.5, 111.6, 111.7, 111.8, 111.9, 112.0, 112.1, 112.2, 112.3, 112.4, 112.5, 112.6, 112.7, 112.8, 112.9, 113.0, 113.1, 113.2, 113.3, 113.4, 113.5, 113.6, 113.7, 113.8, 113.9, 114.0, 114.1, 114.2, 114.3, 114.4, 114.5, 114.6, 114.7, 114.8, 114.9, 115.0, 115.1, 115.2, 115.3, 115.4, 115.5, 115.6, 115.7, 115.8, 115.9, 116.0, 116.1, 116.2, 116.3, 116.4, 116.5, 116.6, 116.7, 116.8, 116.9, 117.0, 117.1, 117.2, 117.3, 117.4, 117.5, 117.6, 117.7, 117.8, 117.9, 118.0, 118.1, 118.2, 118.3, 118.4, 118.5, 118.6, 118.7, 118.8, 118.9, 119.0, 119.1, 119.2, 119.3, 119.4, 119.5, 119.6, 119.7, 119.8, 119.9, 120.0, 120.1, 120.2, 120.3, 120.4, 120.5, 120.6, 120.7, 120.8, 120.9, 121.0, 121.1, 121.2, 121.3, 121.4, 121.5, 121.6, 121.7, 121.8, 121.9, 122.0, 122.1, 122.2, 122.3, 122.4, 122.5, 122.6, 122.7, 122.8, 122.9, 123.0, 123.1, 123.2, 123.3, 123.4, 123.5, 123.6, 123.7, 123.8, 123.9, 124.0, 124.1, 124.2, 124.3, 124.4, 124.5, 124.6, 124.7, 124.8, 124.9, 125.0, 125.1, 125.2, 125.3, 125.4, 125.5, 125.6, 125.7, 125.8, 125.9, 126.0, 126.1, 126.2, 126.3, 126.4, 126.5, 126.6, 126.7, 126.8, 126.9, 127.0, 127.1, 127.2, 127.3, 127.4, 127.5, 127.6, 127.7, 127.8, 127.9, 128.0, 128.1, 128.2, 128.3, 128.4, 128.5, 128.6, 128.7, 128.8, 128.9, 129.0, 129.1, 129.2, 129.3, 129.4, 129.5, 129.6, 129.7, 129.8, 129.9, 130.0, 130.1, 130.2, 130.3, 130.4, 130.5, 130.6, 130.7, 130.8, 130.9, 131.0, 131.1, 131.2, 131.3, 131.4, 131.5, 131.6, 131.7, 131.8, 131.9, 132.0, 132.1, 132.2, 132.3, 132.4, 132.5, 132.6, 132.7, 132.8, 132.9, 133.0, 133.1, 133.2, 133.3, 133.4, 133.5, 133.6, 133.7, 133.8, 133.9, 134.0, 134.1, 134.2, 134.3, 134.4, 134.5, 134.6, 134.7, 134.8, 134.9, 135.0, 135.1, 135.2, 135.3, 135.4, 135.5, 135.6, 135.7, 135.8, 135.9, 136.0, 136.1, 136.2, 136.3, 136.4, 136.5, 136.6, 136.7, 136.8, 136.9, 137.0, 137.1, 137.2, 137.3, 137.4, 137.5, 137.6, 137.7, 137.8, 137.9, 138.0, 138.1, 138.2, 138.3, 138.4, 138.5, 138.6, 138.7, 138.8, 138.9, 139.0, 139.1, 139.2, 139.3, 139.4, 139.5, 139.6, 139.7, 139.8, 139.9, 140.0, 140.1, 140.2, 140.3, 140.4, 140.5, 140.6, 140.7, 140.8, 140.9, 141.0, 141.1, 141.2, 141.3, 141.4, 141.5, 141.6, 141.7, 141.8, 141.9, 142.0, 142.1, 142.2, 142.3, 142.4, 142.5, 142.6, 142.7, 142.8, 142.9, 143.0, 143.1, 143.2, 143.3, 143.4, 143.5, 143.6, 143.7, 143.8, 143.9, 144.0, 144.1, 144.2, 144.3, 144.4, 144.5, 144.6, 144.7, 144.8, 144.9, 145.0, 145.1, 145.2, 145.3, 145.4, 145.5, 145.6, 145.7, 145.8, 145.9, 146.0, 146.1, 146.2, 146.3, 146.4, 146.5, 146.6, 146.7, 146.8, 146.9, 147.0, 147.1, 147.2, 147.3, 147.4, 147.5, 147.6, 147.7, 147.8, 147.9, 148.0, 148.1, 148.2, 148.3, 148.4, 148.5, 148.6, 148.7, 148.8, 148.9, 149.0, 149.1, 149.2, 149.3, 149.4, 149.5, 149.6, 149.7, 149.8, 149.9, 150.0, 150.1, 150.2, 150.3, 150.4, 150.5, 150.6, 150.7, 150.8, 150.9, 151.0, 151.1, 151.2, 151.3, 151.4, 151.5, 151.6, 151.7, 151.8, 151.9, 152.0, 152.1, 152.2, 152.3, 152.4, 152.5, 152.6, 152.7, 152.8, 152.9, 153.0, 153.1, 153.2, 153.3, 153.4, 153.5, 153.6, 153.7, 153.8, 153.9, 154.0, 154.1, 154.2, 154.3, 154.4, 154.5, 154.6, 154.7, 154.8, 154.9, 155.0, 155.1, 155.2, 155.3, 155.4, 155.5, 155.6, 155.7, 155.8, 155.9, 156.0, 156.1, 156.2, 156.3, 156.4, 156.5, 156.6, 156.7, 156.8, 156.9, 157.0, 157.1, 157.2, 157.3, 157.4, 157.5, 157.6, 157.7, 157.8, 157.9, 158.0, 158.1, 158.2, 158.3, 158.4, 158.5, 158.6, 158.7, 158.8, 158.9, 159.0, 159.1, 159.2, 159.3, 159.4, 159.5, 159.6, 159.7, 159.8, 159.9, 160.0, 160.1, 160.2, 160.3, 160.4, 160.5, 160.6, 160.7, 160.8, 160.9, 161.0, 161.1, 161.2, 161.3, 161.4, 161.5, 161.6, 161.7, 161.8, 161.9, 162.0, 162.1, 162.2, 162.3, 162.4, 162.5, 162.6, 162.7, 162.8, 162.9, 163.0, 163.1, 163.2, 163.3, 163.4, 163.5, 163.6, 163.7, 163.8, 163.9, 164.0, 164.1, 164.2, 164.3, 164.4, 164.5, 164.6, 164.7, 164.8, 164.9, 165.0, 165.1, 165.2, 165.3, 165.4, 165.5, 165.6, 165.7, 165.8, 165.9, 166.0, 166.1, 166.2, 166.3, 166.4, 166.5, 166.6, 166.7, 166.8, 166.9, 167.0, 167.1, 167.2, 167.3, 167.4, 167.5, 167.6, 167.7, 167.8, 167.9, 168.0, 168.1, 168.2, 168.3, 168.4, 168.5, 168.6, 168.7, 168.8, 168.9, 169.0, 169.1, 169.2, 169.3, 169.4, 169.5, 169.6, 169.7, 169.8, 169.9, 170.0, 170.1, 170.2, 170.3, 170.4, 170.5, 170.6, 170.7, 170.8, 170.9, 171.0, 171.1,

CERTIFICATIONS APPROVALS



QMS (Quality Management System)

ISO 9001 : 2015

EMS (Environment Management System)

ISO 14001 : 2015

OHSAS (Occupational Health & Safety Management System)

ISO 45001 : 2018

IBR
PISTON VALVE
GLOBE CONTROL VALVE (CKD/CND)
DISC CHECK VALVE (DCV)
PRESSURE REDUCING VALVE (PRV)
POP TYPE SAFETY VALVE
BALL VALVE

Pneumatic Actuator

CE /
ATEX /
EXIDA SIL-3 /
PROOF OF DESIGN

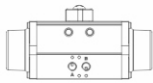

Scotch & Yoke Actuator

CE / ATEX / SIL-3

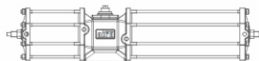

Stainless Steel Actuator

CE /
IEP ATEX

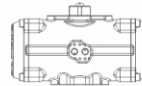

Positioner Enclosure

CE / CIMFR /
IP67 / BIS
/ PESO

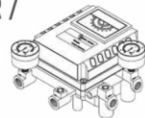

aira's
SOME OF OUR
Certificates

Plug Valve

FUGITIVE EMISSIONS
TEST
AS PER ISO
15848-1 / IBR

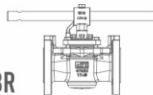

Flameproof Solenoid Valve

IEP ATEX / CE / CIMFR
/ IP65/ IP67 / IP68 /
BIS / PESO



Limit Switch

IEP ATEX / CE / CIMFR
/ IP67 / BIS / PESO /
EQDC IP68



Ball Valve (Floating & Trunnion)

FIRE SAFE TEST DESIGN /
FUGITIVE EMISSIONS TEST
AS PER ISO 15848-1 / CE /
PED /
EXIDA SIL-3

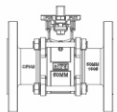

Butterfly Valve (centric / Double & Triple Eccentric)

FIRE SAFE TEST DESIGN /
FUGITIVE EMISSIONS TEST
AS PER ISO 15848-1 / CE /
PED / EXIDA SIL-3
/ IBR / PROOF OF DESIGN /
FOOD GRADE / BIS / ISI



Multiport Ball Valve

FUGITIVE EMISSIONS TEST
AS PER ISO 15848-1 / CE /
PED / EIL

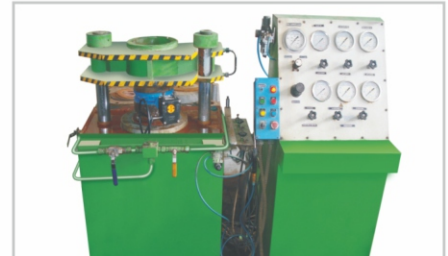
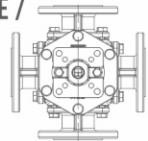

WAFER TYPE EXPLODED BALL VALVE

OPERATING VARIANTS :



MATERIALS :

Item No.	Item Name	Material Name
1	Body	CF8 / CF8M
2	Insert	CF8 / CF8M
3	Ball	CF8 / CF8M
4	Ball Seat	PTFE
5	Body Seat	PTFE
6	Stem Pin	S.S. 304
7	Stem Seat	PTFE
8	Gland Bush	S.S. 304
9	Gland Bolt	S.S. 304
10	Bracket	CF8 / CF8M
11	Fasteners	S.S. 304

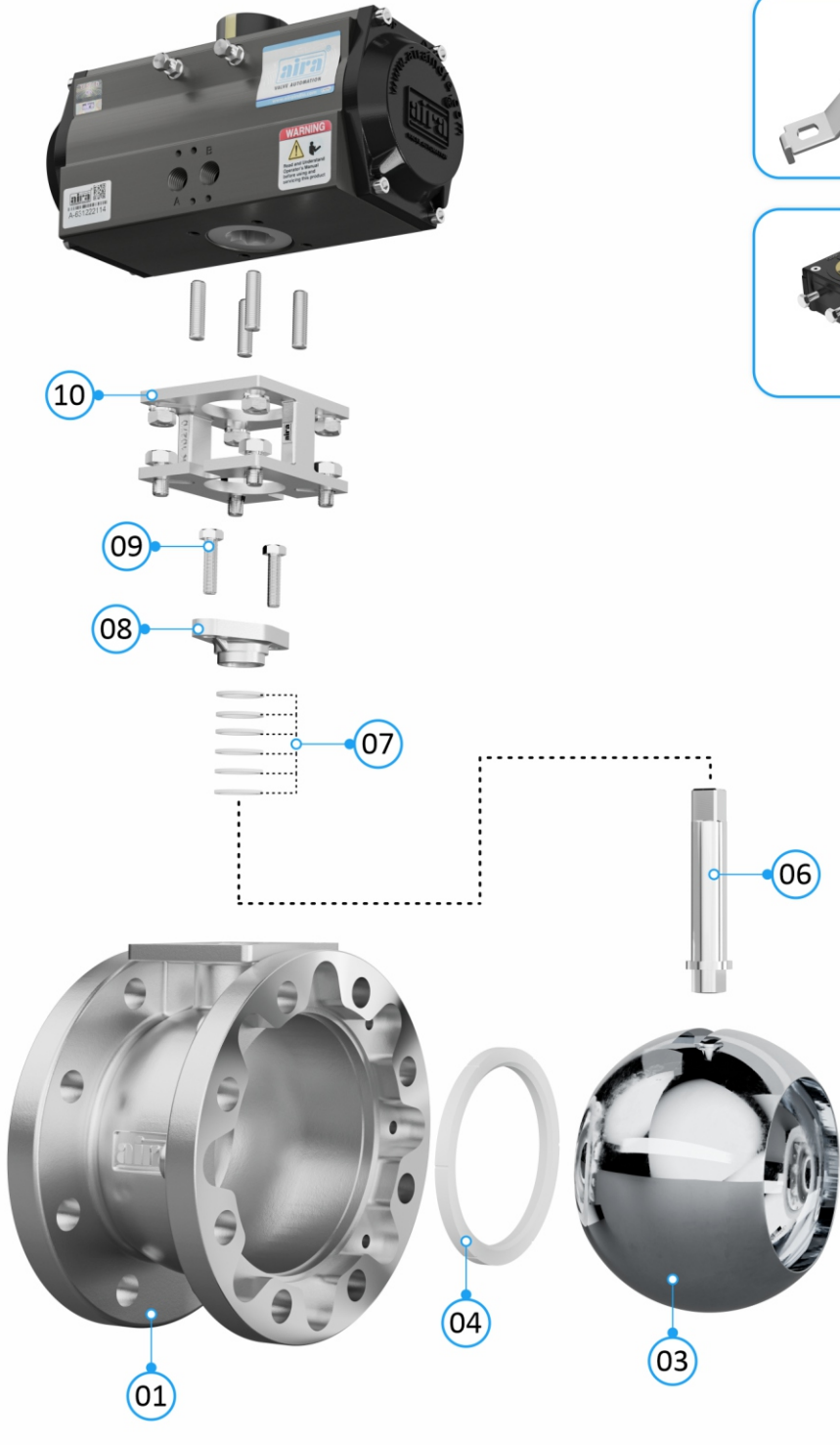

WAFER TYPE FLANGED BALL VALVE

“aira” Offers Manual & Automation Operated Investment Casting WCB / CF8 / CF8M / CF3M Wafer Type Floating Ball Valve. Wafer Type Ball Valve Application Chemical Product. Food Plants, Distribution Line For Gas, Air, Water.

Standard

- **Design & Manufacturer** : ASME B 16.34 / BS EN ISO 17292
- **Valve Face To Face Dimension** : As Per Manufacturer Std.
- **Inspection & Testing** : API 598 / ISO-5208 / BS EN 12266-1
- **Leakage Class** : ISO 5208 Class VI / ANSI FCI 70-2 B16.104
- **Flange Standard Conformity** : ASME B 16.5 Class 150

Technical Specification

- **Pressure** : Upto 10 Kg/cm² for 150#
- **Temperature** : PTFE : Upto 180°C

Features

- Compact Single Piece Design.
- Blow Out Proof Stem.
- ISO 5211 Mounting Pad.

SIZE RANGE 1" UPTO 4" WAFER TYPE

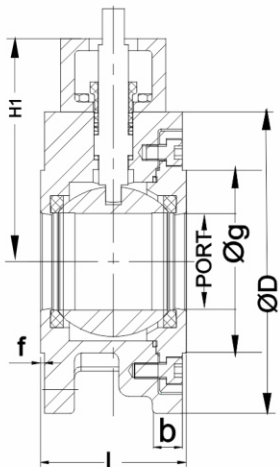
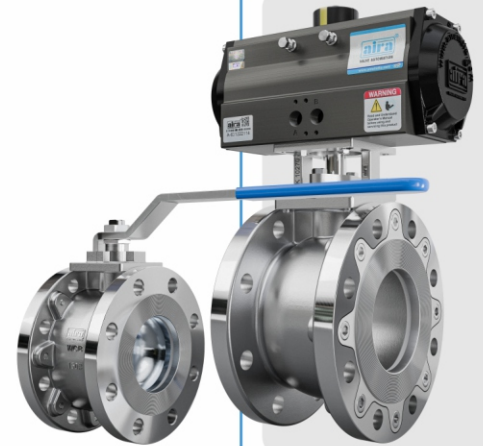

Bare Shaft

Dimensions :

Valve Size	+3.0 -3.0	+1.0 -0.0	+2.0 -1.0	+1.0 -1.0	+3.0 -0.0	+0.5 -0.5	ØJ	N	+1.5 -1.5	+5.0 -5.0	+3.0 -3.0	+10.0 -10.0
L-150#	PORT	ØD	Øg	b	f				K:PCD	H	HI	W
25 MM	55	25	110	50.8	9.6	2	15.88	4	79.4	96	86	162
32 MM	59	32	115	63.5	11.2	2	15.88	4	88.9	97	95	183
40 MM	63	38	125	73	12.7	2	15.88	4	98.4	116	100	256
50 MM	73	49	150	92.1	14.3	2	19.05	4	120.7	138	101	256
65 MM	96	62	180	104.8	15.9	2	19.05	4	139.7	270	127	161
80 MM	118	74	190	127	17.5	2	19.05	4	152.4	171	133	270
100 MM	140	100	230	157.2	22.3	2	19.05	8	190.5	202	173	423

*All Dimensions Are In MM

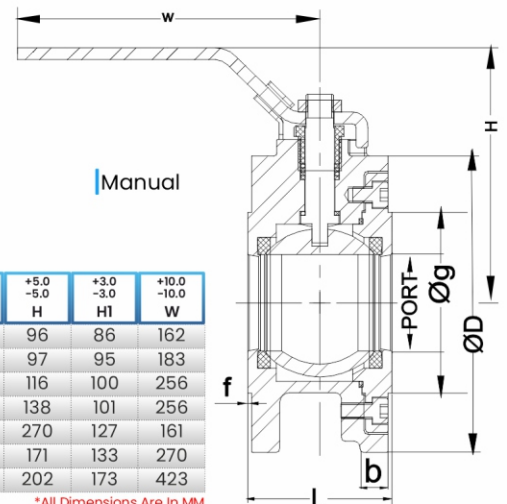

Manual



*time tested designs with
superior performance*

GLOBAL Network



▲ International Dealers

AUSTRALIA	MALAYSIA	VIETNAM
BAHRAIN	MEXICO	NIGERIA
BANGLADESH	NEPAL	YEMEN
BHUTAN	OMAN	ZIMBABWE
BRAZIL	PARAGUAY	
CHILE	PERU	
COLOMBIA	PHILIPPINES	
ECUADOR	QATAR	
EGYPT	RUSSIA	
FIJI	SINGAPORE	
INDONESIA	SOUTH AFRICA	
IRAN	SRI LANKA	
IRAQ	TAIWAN	
IRELAND	TANZANIA	
ITALY	TURKEY	
JORDAN	UAE	
KAZAKHSTAN	UGANDA	
KENYA	UK	
KSA	USA	
MALAWI	UZBEKISTAN	



industrial valve automation

Network

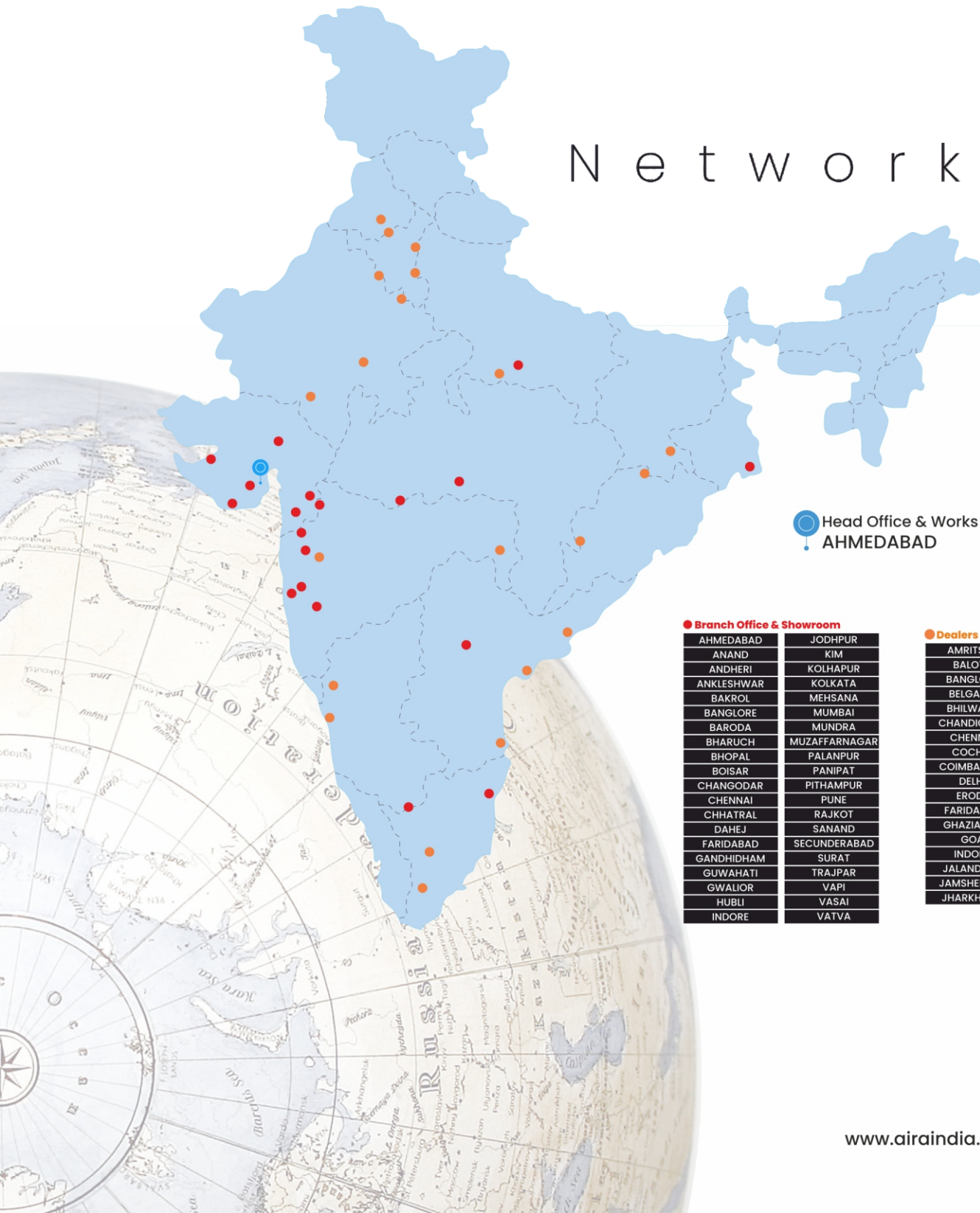

Head Office & Works
AHMEDABAD

● Branch Office & Showroom

AHMEDABAD	JODHPUR
ANAND	KIM
ANDHERI	KOLHAPUR
ANKLESHWAR	KOLKATA
BAKROL	MEHSANA
BANGLORE	MUMBAI
BARODA	MUNDRA
BHARUCH	MUZAFFARNAGAR
BHOPAL	PALANPUR
BOISAR	PANIPAT
CHANGODAR	PITHAMPUR
CHENNAI	PUNE
CHHATRAL	RAJKOT
DAHEJ	SANAND
FARIDABAD	SECUNDERABAD
GANDHIDHAM	SURAT
GUWAHATI	TRAJPAR
GWALIOR	VAPI
HUBLI	VASAI
INDORE	VATVA

● Dealers & Distributors

AMRITSAR	KOLKATA
BALOTA	LUCKNOW
BANGLORE	LUDHIANA
BELGAUM	MARWAR
BHILWARA	MEERUT
CHANDIGARH	MUZAFFARNAGAR
CHENNAI	NAGPUR
COCHIN	NOIDA
COIMBATORE	PANIPAT
DELHI	PEENYA
ERODE	PUNE
FARIDABAD	TRIPUR
GHAZIABAD	VARANASI
GOA	VISAKHAPATNAM
INDORE	WADI
JALANDHAR	KANPUR
JAMSHEDPUR	KOLHAPUR
JHARKHAND	

WAFER TYPE DESIGN

Ball Valve



Mfg. & Mkt by :

aira Euro automation pvt. ltd.

Ahmedabad-382405, INDIA.

www.airaindia.com